

# InBioPC-800

## Professional Primary Controller

Compatible with

 **ZKBio** CVSecurity



The **InBioPC-800** Main Controller is the pinnacle of access control technology, offering seamless integration with DE-10 Door Units and supporting up to 8 access points. Engineered for high-speed TCP/IP communication, it ensures efficient and reliable data transfer. The onboard webserver, accessible via Wi-Fi, simplifies system configuration, providing unparalleled ease of use. Compliant with power over ethernet (PoE IEEE802.3 and PSE@30W) standards, the InBioPC-800 can power up to 8 DE-10 Door Units, delivering both performance and convenience.

This advanced controller boasts a suite of sophisticated access control functions and supports dynamic QR code generation through the ZKBio CVSecurity Mobile Applications, enhancing security and user experience. With support for InBioPC-800 offers versatile authentication methods to meet diverse security needs. Its compatibility with the ZKTeco A&C push protocol ensures seamless communication with ZKBio CVSecurity software.

Operating within a wide voltage input range of AC 100V~240V, the InBioPC-800 is designed for global deployment. It incorporates high-security data encryption methods, including HTTP / HTTPS, SSH, AES256, and TLS 2.0, safeguarding sensitive information. Supporting both Wiegand readers (formats: W26 / W34 / W66) and RS485 card readers (protocol: ZKTeco RS-485), it provides flexible connectivity options.

Furthermore, the InBioPC-800 is designed in a standard 1U server rack size, ensuring compatibility with standard server rack installations. This makes it an ideal choice for organizations looking to deploy a robust, scalable, and secure access control solution.

## Features

- Seamlessly integrates with DE-10 Door Units, supporting up to 8 access points.
- Supports high-speed TCP/IP communication for efficient data transfer.
- An embedded onboard webserver is available for system configuration and is accessible via Wi-Fi.
- Complies with IEEE 802.3 at PoE and PSE@30W standards to power up to 8 DE-10 Door Units.
- Equipped with advanced access control functions for enhanced security.
- Supports dynamic QR code generation with ZKBio CVSecurity Mobile Applications.
- Supports multiple credential options, including biometrics, RFID, and password.
- Compatible with the A&C push protocol.
- Operates with a wide voltage input range of AC 100V~240V.
- Supports high-security data encryption methods such as HTTP / HTTPS, SSH, AES256, and TLS 2.0.
- Supports Wiegand readers (formats: W26 / W34 / W66) and RS485 card readers (protocol: ZKTeco RS-485)
- Designed in standard 1U server rack size to be compatible with standard server rack installation.

## Specifications

Model	InBioPC-800
Onboard Visual Indicator	POWER (RED): ON-Power Normal,OFF-No Power RUN (GREEN): Slow Flashing-Normal Use, Flashing-Host not connected, OFF-No Power LAN (GREEN): Steady on-No data interaction, Flashing-Data in Interaction, OFF-Network Connection Abnormal FIRE (RED): Flashing-In Fire Alarm, OFF-No Fire Alarm AUX IN (RED): Flashing-In Alarm, OFF-No Alarm DOOR (GREEN): Steady ON-Door Closed, Flashing-Door Open, OFF-Lock Offline
Operation System	Linux
Hardware	CPU: Dual Core@1.0GHz RAM: 128MB; ROM: 256MB
Authentication Method	Card / Password / Fingerprint / QR code
Access Point Capacity	Onboard Access Point: 0 Max Access Point: 8 (with DE-10 Door Unit)
Reader Capacity	N/A
IO Expansion Board Capacity	N/A
Authentication Method	Card / Password / Fingerprint / QR code
Supported Primary Controller	N/A
Fingerprint Template Capacity	4,000 (1:N) (Standard)
Card Capacity	40,000 (1:N) (Standard)
QR Code Capacity	40,000 (QR Code and Dynamic QR Code)
User Capacity	40,000
Transaction Capacity	200,000 (Standard)

Number of Inputs	1 * AUX Inputs, 1 * FIRE
Number of Outputs	1 * Form C Relay for Aux Output 1 * Form C Relay for Alarm
Supported Biometric Algorithm	ZKFingerprint V10.0
Max. Card Length	Supports up to 66 bits Card Length
QR Code	Dynamic QR codes on the ZKBio CVSecurity mobile application QR code
Communication	TCP/IP * 1 Wi-Fi (IEEE802.11b/g/n/, 1T1R @ 2.4 GHz ) (Wi-Fi only for webserver access)
Standard Functions	Webserver, Upto 14-digit User ID, Access Levels, Access Groups, Holidays, Anti-passback, Anti-tailgating, Linkage, Global Linkage, Multiple Verification Methods
Optional Functions	N/A
Access Control Interface	N/A (Managed by Door Unit)
Verification Speed	less than 0.3 sec (Fingerprint)
Power Supply	Power Input: AC 100V~240V Power Output: POE ( IEEE802.3at@PSE@30W output) * 8
Operating Temperature	0°C to 45°C
Operating Humidity	20% to 80% RH (Non-condensing)
Dimensions	440 mm * 180 mm * 45 mm (L * W * H) (Standard 1U Server Rack Size)
Gross Weight	2.825 Kg
Net Weight	2.179Kg
Supported Software	ZKBio CVSecurity
Installation	Supported Rack-mount (Compatible with Standard Server Rack) Wall-mount Desktop
Enclosure (Optional)	N/A
Housing Material	SGCC
Certifications	ISO14001, ISO9001, CE, FCC, RoHS
Factory ID	AC02-CB608H-16

## Cable Requirement

Power & Relays	One twisted pair, 18 - 16 AWG
Ethernet	CAT-5, minimum 330 ft. (100m)
RS-485 Reader Port	9600 - 115200 bps, asynchronous, half-duplex, 1 start bit, 8 data bits, and 1 stop bit One twisted pair with drain wire and shield, 120 ohm resistance. 22 - 18 AWG. Maximum cable length: 3937ft (1200m)
Wiegand Port	20 AWG shielded Wiegand wire, 328ft. (100m)

## Configuration

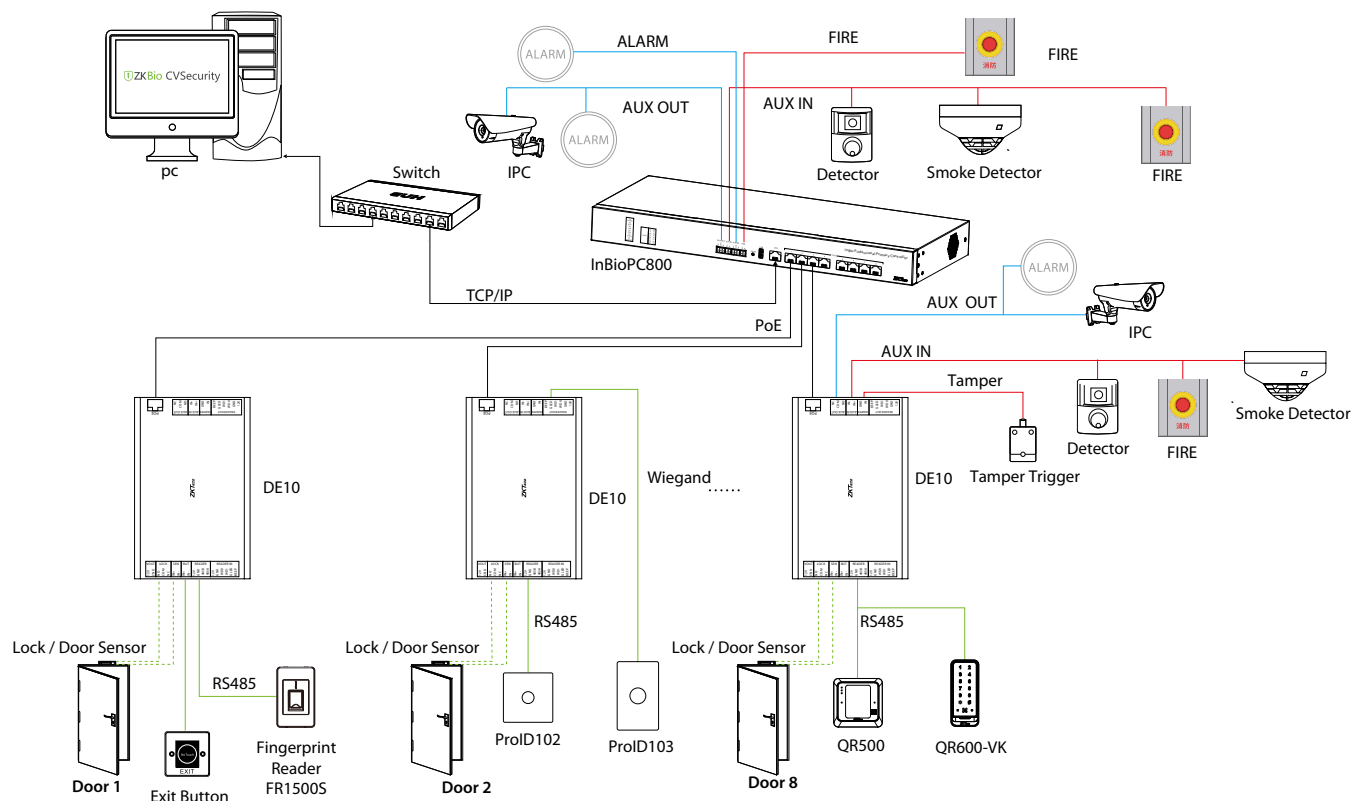

## Dimensions (mm)

